



**TR3.0**

# TREADMILL OWNER'S MANUAL



# IMPORTANT PRECAUTIONS



## SAVE THESE INSTRUCTIONS

When using an electrical product, basic precautions should always be followed, including the following: Read all instructions before using this treadmill. It is the responsibility of the owner to ensure that all users of this treadmill are adequately informed of all warnings and precautions. If you have any questions after reading this guide, contact Customer Tech Support at the number listed on the back panel of the OWNER'S MANUAL.

This treadmill is intended for in-home use only. Do not use this treadmill in any commercial, rental, school or institutional setting. Failure to comply will void the warranty.



## **DANGER**

### **TO REDUCE THE RISK OF ELECTRICAL SHOCK:**

Always unplug the treadmill from the electrical outlet immediately after using, before cleaning, performing maintenance and putting on or taking off parts.

## **WARNING**

### **TO REDUCE THE RISK OF BURNS, FIRE, ELECTRICAL SHOCK OR INJURY TO PERSONS:**

- Never use the treadmill before securing the safety tether clip to your clothing.
- If you experience any kind of pain, including but not limited to chest pains, nausea, dizziness, or shortness of breath, stop exercising immediately and consult your physician before continuing.
- When exercising, always maintain a comfortable pace.
- Do not wear clothes that might catch on any part of the treadmill.
- Always wear athletic shoes while using this equipment.
- Do not jump on the treadmill.
- At no time should more than one person be on treadmill while in operation.
- This treadmill should not be used by persons weighing more than specified in the OWNER'S MANUAL WARRANTY SECTION. Failure to comply will void the warranty.
- When lowering the treadmill deck, wait until rear feet are firmly on the floor before stepping on the deck.
- Disconnect all power before servicing or moving the equipment. To clean, wipe surfaces down with soap and slightly damp cloth only; never use solvents. (See MAINTENANCE)
- The treadmill should never be left unattended when plugged in. Unplug from outlet when not in use, and before putting on or taking off parts.
- Do not operate under blanket or pillow. Excessive heating can occur and cause fire, electric shock, or injury to persons.
- Connect this exercise product to a properly grounded outlet only.

# WARNING

## TO REDUCE THE RISK OF BURNS, FIRE, ELECTRICAL SHOCK OR INJURY TO PERSONS:

- At NO time should pets or children under the age of 13 be closer to the treadmill than 10 feet.
- At NO time should children under the age of 13 use the treadmill.
- Children over the age of 13 or disabled persons should not use the treadmill without adult supervision.
- Use the treadmill only for its intended use as described in the treadmill guide and owner's manual.
- Do not use other attachments that are not recommended by the manufacturer. Attachments may cause injury.
- Never operate the treadmill if it has a damaged cord or plug, if it is not working properly, if it has been dropped or damaged, or immersed in water. Return the treadmill to a service center for examination and repair.
- Keep power cord away from heated surfaces. Do not carry this unit by its supply cord or use the cord as a handle.
- Never operate the treadmill with the air opening blocked. Keep the air opening clean, free of lint, hair, and the like.
- To prevent electrical shock, never drop or insert any object into any opening.
- Do not operate where aerosol (spray) products are being used or when oxygen is being administered.
- To disconnect, turn all controls to the off position, then remove plug from outlet.
- Do not use treadmill in any location that is not temperature controlled, such as but not limited to garages, porches, pool rooms, bathrooms, car ports or outdoors. Failure to comply will void the warranty.
- This treadmill is intended for in-home use only. Do not use this treadmill in any commercial, rental, school or institutional setting. Failure to comply will void the warranty.
- Do not remove the console covers unless instructed by Customer Tech Support. Service should only be done by an authorized service technician.

It is essential that your treadmill is used only indoors, in a climate controlled room. If your treadmill has been exposed to colder temperatures or high moisture climates, it is strongly recommended that the treadmill is warmed up to room temperature before first time use. Failure to do so may cause premature electronic failure.





## GROUNDING INSTRUCTIONS

This product must be grounded. If a treadmill should malfunction or breakdown, grounding provides a path of least resistance for electrical current to reduce the risk of electrical shock. This product is equipped with a cord having an equipment-grounding conductor and a grounding plug. The plug must be plugged into an appropriate outlet that is properly installed and grounded in accordance with local codes and ordinances.

### DANGER

Improper connection of the equipment-grounding conductor can result in a risk of electric shock. Check with a qualified electrician or service provider if you are in doubt as to whether the product is properly grounded. Do not modify the plug provided with the product. If it will not fit the outlet, have a proper outlet installed by a qualified electrician.

Make sure that the product is connected to an outlet having the same configuration as the plug. No adapter should be used with this product.

This product must be used on a dedicated circuit. To determine if you are on a dedicated circuit, shut off the power to that circuit and observe if any other devices lose power. If so, move devices to a different circuit. Note: There are usually multiple outlets on one circuit.

### WARNING

Connect this exercise product to a properly grounded outlet only.

Never operate product with a damaged cord or plug even if it is working properly. Never operate any product if it appears damaged, or has been immersed in water. Contact Customer Tech Support for replacement or repair.

Place the treadmill on a level and stable surface. There should be one foot of clearance in front of the treadmill for the power cord. Please leave a clear zone behind the treadmill that is at least the width of the treadmill and at least 79" (2 meters) long. This zone must be clear of any obstruction and provide the user a clear exit path from the machine. In case of an emergency, place both hands on the side arm rests to hold yourself up and place your feet onto the side rails. For ease of access, there should be a accessible space preferentially on both sides of the treadmill equal to 2 ft (0.6 meters) to allow a user access to the treadmill from either side. Do not place the treadmill in any area that will block any vent or air openings. The treadmill should not be located in a garage, covered patio, near water or outdoors.

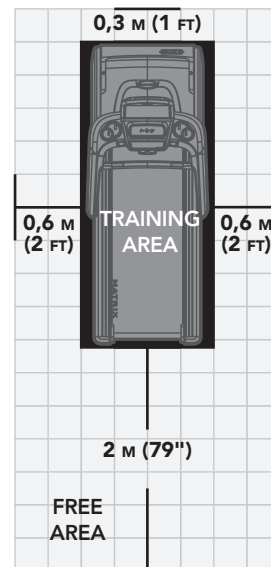



# ASSEMBLY



## ⚠ WARNING

There are several areas during the assembly process that special attention must be paid. It is very important to follow the assembly instructions correctly and to make sure all parts are firmly tightened. If the assembly instructions are not followed correctly, the treadmill could have parts that are not tightened and will seem loose and may cause irritating noises. To prevent damage to the treadmill, the assembly instructions must be reviewed and corrective actions should be taken.

Before proceeding, find your treadmill's serial number located on a white barcode sticker near the on/off power switch and power cord and enter it in the space provided below.

ENTER YOUR SERIAL NUMBER AND MODEL NAME IN THE BOXES BELOW:

SERIAL NUMBER:

TM

## SERIAL NUMBER LOCATION

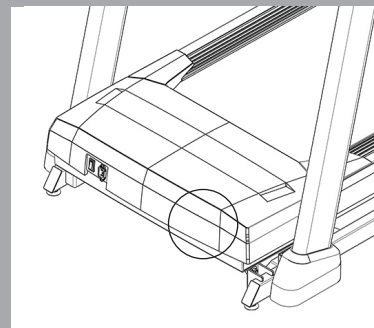

MODEL NAME: **HORIZON**

**TREADMILL**

» Refer to the SERIAL NUMBER and MODEL NAME when calling for service.

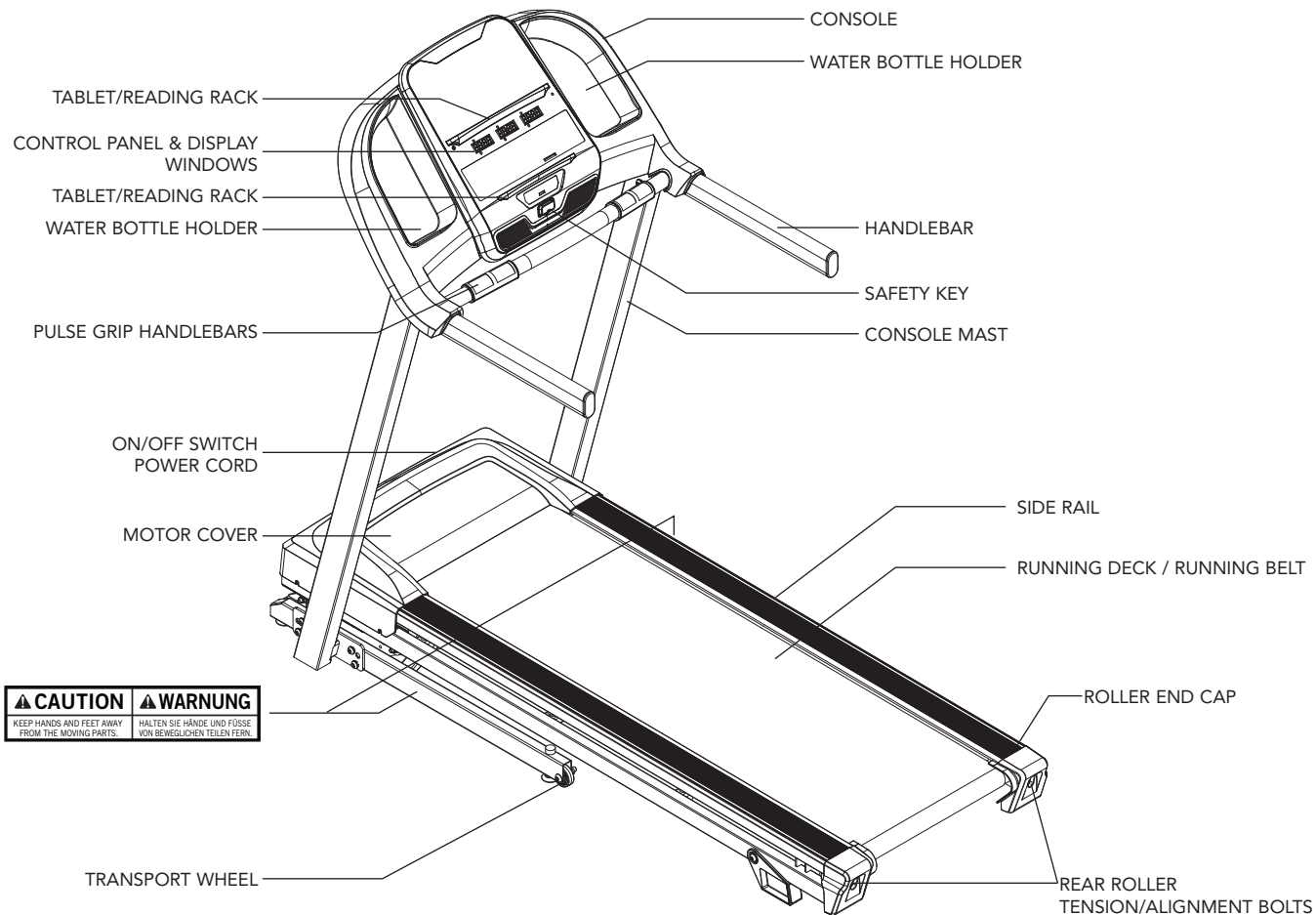

## TOOLS INCLUDED:

- ☐ 5 mm L-Wrench
- ☐ 6 mm T-Wrench

## PARTS INCLUDED:

- ☐ 1 Console Assembly
- ☐ 2 Console Masts
- ☐ 1 Hardware Kit
- ☐ 1 Safety Key
- ☐ 1 Bottle of Silicone Lubricant  
(for 2 applications)
- ☐ 1 Power Cord
- ☐ 2 Handlebars



## NEED HELP?

If you have questions or if there are any missing parts, contact Customer Tech Support.

## PRE ASSEMBLY

### WARNING

DO NOT ATTEMPT TO LIFT THE TREADMILL! Do not move or lift treadmill from packaging until specified to do so in the assembly instructions. You may remove the plastic wrap from console masts.

## UNPACKING

Place the treadmill carton on a level flat surface. It is recommended that you place a protective covering on your floor. Take CAUTION when handling and transporting this unit. Never open box when it is on its side. Once the banding straps have been removed, do not lift or transport this unit unless it is fully assembled and in the upright folded position, with the lock latch secure. Unpack and assemble the unit where it will be used. The enclosed treadmill is equipped with high-pressure shocks and may spring open if mishandled. Never grab hold of any portion of the incline frame and attempt to lift or move the treadmill.

### WARNING

FAILURE TO FOLLOW THESE INSTRUCTIONS COULD RESULT IN INJURY!

NOTE: During each assembly step, ensure that ALL nuts and bolts are in place and partially threaded in before completely tightening any ONE bolt.

NOTE: A light application of grease may aid in the installation of hardware. Any grease, such as lithium bike grease is recommended.





# ASSEMBLY STEP 1

HARDWARE FOR STEP 1

PART	TYPE	DESCRIPTION	QTY
A	BOLT	M8X1.25PX20L	4
B	SPRING WASHER	8.2X15.4X2T	4
C	FLAT WASHER	8.4X15.5X1.6T	4

- A Open **HARDWARE FOR STEP 1**.
- B Attach the **LEFT CONSOLE MAST (1)** to the **BASE FRAME (3)** using **4 BOLTS (A)**, **4 SPRING WASHERS (B)** and **4 FLAT WASHERS (C)**.

NOTE: Do not fully tighten bolts until **STEP 4**.

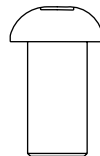
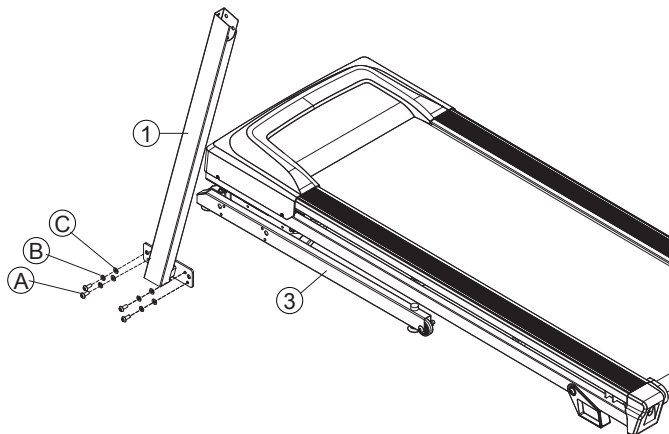

A



B

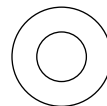

C

# ASSEMBLY STEP 2



HARDWARE FOR STEP 2			
PART	TYPE	DESCRIPTION	QTY
A	BOLT	M8X1.25PX20L	4
B	SPRING WASHER	8.2X15.4X2T	4
C	FLAT WASHER	8.4X15.5X1.6T	4

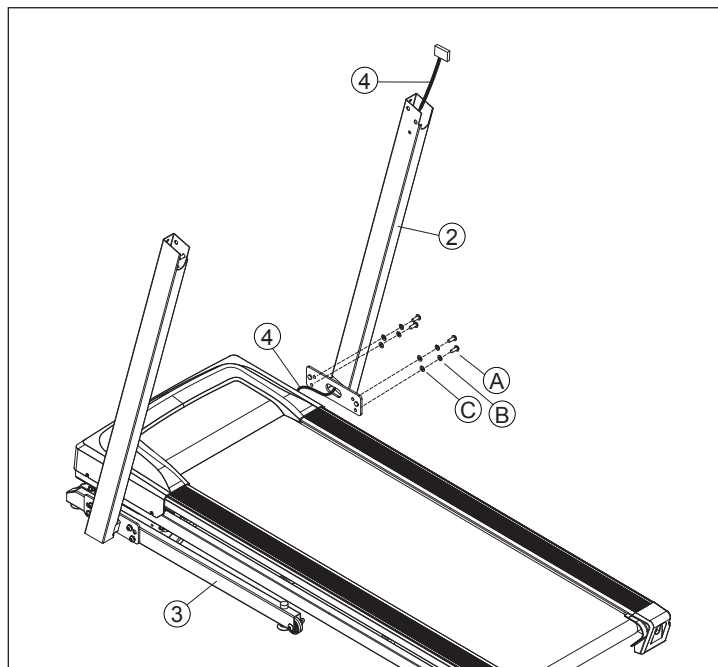

- A Open **HARDWARE FOR STEP 2**.
- B Attach **LEAD WIRE (4)** to bottom end of **CONSOLE CABLE (4)**. Pull **LEAD WIRE** through **RIGHT CONSOLE MAST (2)**. After pulling the lead wire through the mast, the top of the **CONSOLE CABLE (4)** should be located at the top of the mast.
- C Attach the **RIGHT CONSOLE MAST (2)** to the **BASE FRAME (3)** using **4 BOLTS (A)**, **4 SPRING WASHERS (B)** and **4 FLAT WASHERS (C)**.

**NOTE:** Do not fully tighten bolts until **STEP 4**.

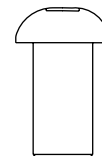

A



B

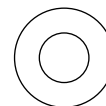

C

## ASSEMBLY STEP 3



HARDWARE FOR STEP 3			
PART	TYPE	DESCRIPTION	QTY
A	BOLT	M8X1.25PX20L	4
B	SPRING WASHER	8.2X15.4X2T	4
C	FLAT WASHER	8.4X15.5X1.6T	4

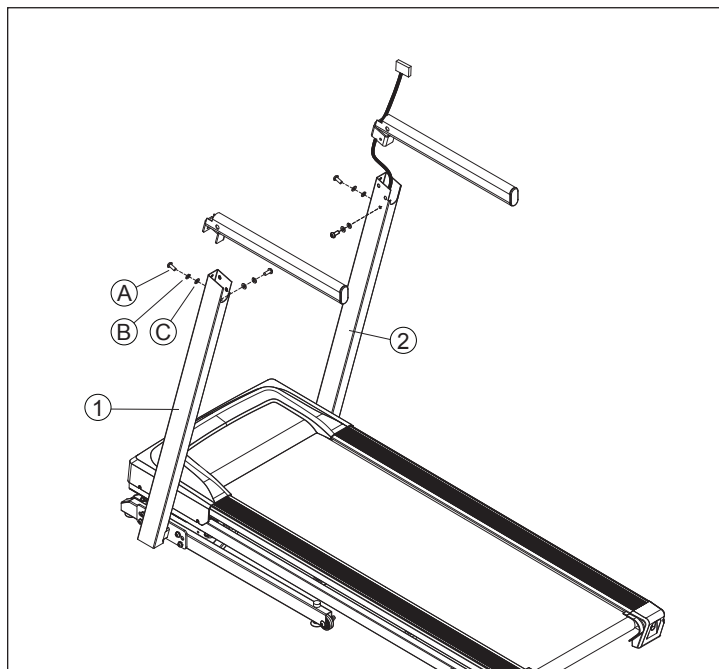

**NOTE:** Be careful not to pinch any wires while assembling the console.

- Pull the **LEAD WIRE** through the bottom end of the **HANDLEBAR**.
- Open **HARDWARE FOR STEP 3**.
- Attach the **HANDLEBAR** to the **LEFT CONSOLE MAST (2)** using **2 BOLTS (A)**, **2 SPRING WASHERS(B)** and **2 FLAT WASHERS (C)**.
- Do the same above for the another **HANDLEBAR**.

**NOTE:** Do not fully tighten bolts until **STEP 5**.

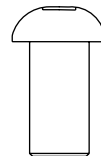

A



B

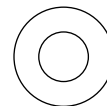

C

# ASSEMBLY STEP 4



HARDWARE FOR STEP 4			
PART	TYPE	DESCRIPTION	QTY
A	BOLT	M8X1.25PX20L	6
B	SPRING WASHER	8.2X15.4X2T	6
C	FLAT WASHER	8.4X15.5X1.6T	6

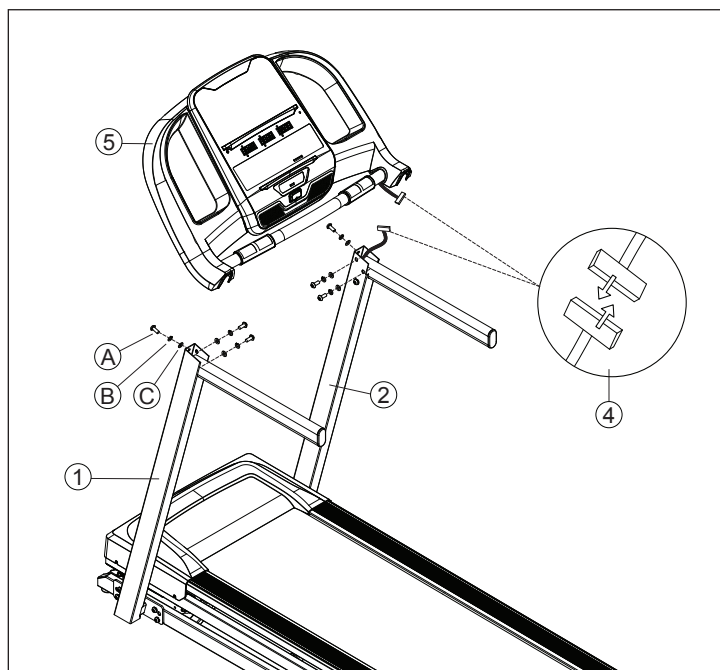

- Open **HARDWARE FOR STEP 4**.
- Gently place the **CONSOLE (5)** on top of the **CONSOLE MASTS (1&2)**. Attach the **LEFT SIDE** first using **3 BOLTS (A)**, **3 SPRING WASHERS (B)** and **3 FLAT WASHERS (C)**.
- The **CONSOLE CABLES (4)** are tucked into the **CONSOLE MAST (2)**. Using the lead wire carefully pull the **CONSOLE CABLE (4)** out of the **CONSOLE MAST (2)**. Detach and discard the **LEAD WIRE**. Connect the **CONSOLE CABLES (4)** and carefully tuck wires in the mast to avoid damage.
- Attach the **RIGHT SIDE** of the **CONSOLE (5)** using **3 BOLTS (A)**, **3 SPRING WASHERS (B)** and **3 FLAT WASHERS (C)**.

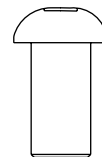

A



B

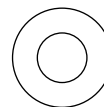

C

## ASSEMBLY STEP 5

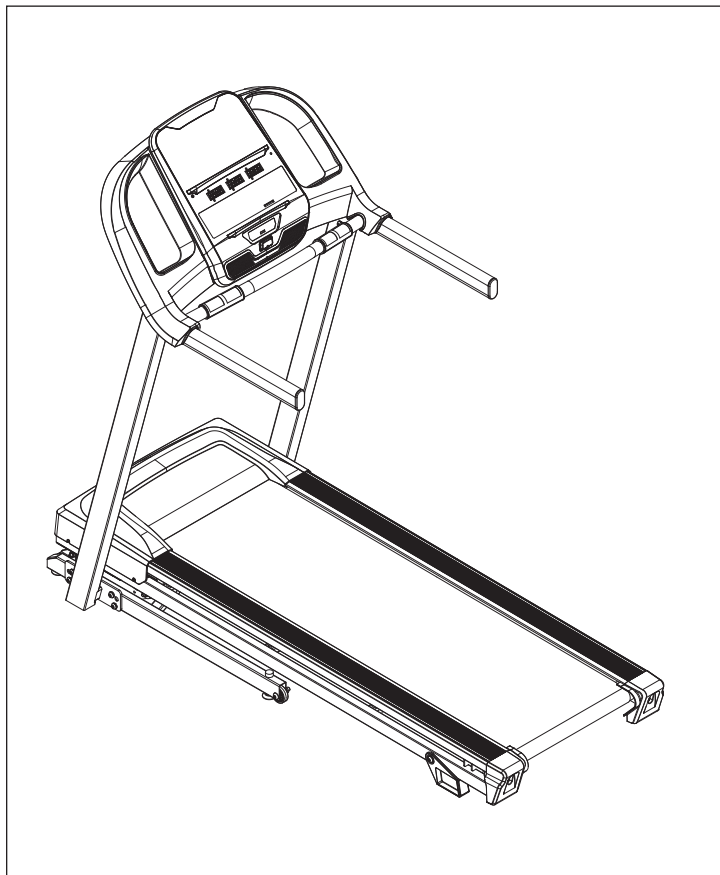

**ASSEMBLY COMPLETE!**

# TREADMILL OPERATION



This section explains how to use your treadmill's console and programming.

The BASIC OPERATION section in the TREADMILL GUIDE has instructions for the following:

- LOCATION OF THE TREADMILL
- USING THE SAFETY KEY
- FOLDING THE TREADMILL
- MOVING THE TREADMILL
- LEVELING THE TREADMILL
- TENSIONING THE RUNNING BELT
- CENTERING THE RUNNING BELT
- USING THE HEART RATE FUNCTION

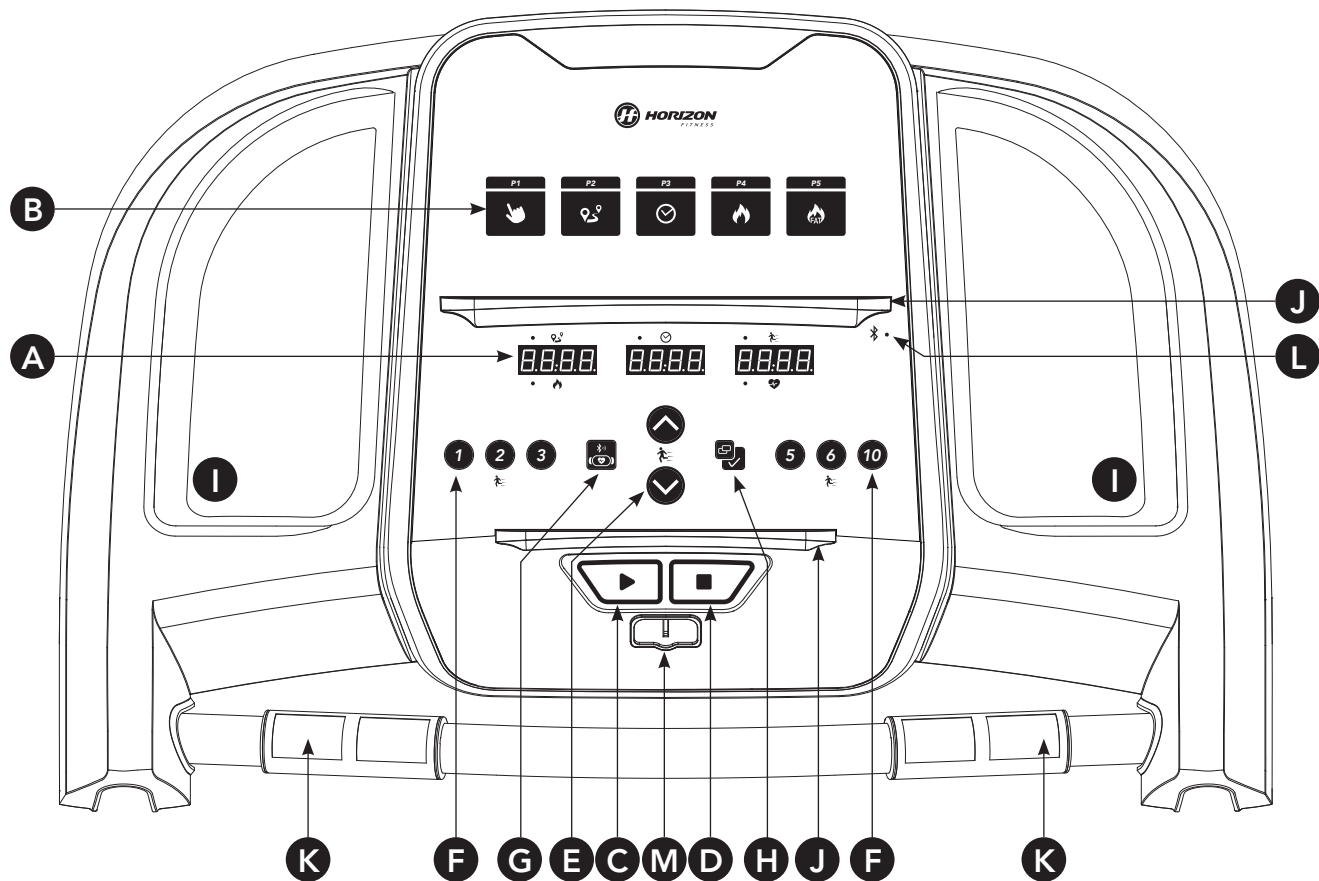

## CONSOLE OPERATION

Note: There is a thin protective sheet of clear plastic on the overlay of the console that should be removed before use.

- A) **LED DISPLAY:** Calories, Time, Distance, Speed, Heart Rate.
- B) **WORKOUT PROGRAMS:** used to reference program code shown on LED display.
- C) **START:** press to begin exercising, start your workout, or resume exercising after pause.
- D) **STOP:** press to pause/end your workout. Hold for 3 seconds to reset the console.
- E) **SPEED +/- KEYS:** used to adjust speed in small increments (0.1 mph increments).
- F) **SPEED QUICK KEYS:** used to reach desired speed more quickly.
- G) **BLUETOOTH HEART RATE:** press and hold 3 sec to connect to the Bluetooth heart rate strap. (APP & BT heart rate strap could only connect one at a time)
- H) **ENTER/CHANGE DISPLAY:** press to select item/press to change display feedback during workout.
- I) **WATER BOTTLE POCKETS:** holds personal workout equipment.
- J) **TABLET/READING RACK:** holds tablet or reading material.
- K) **HEART RATE PULSE GRIPS:** used to measure heart rate.
- L) **BLUETOOTH:** the light will be consistently on once the Bluetooth was connected.
- M) **SAFETY KEY:** the safety key need to plug in to turn on the treadmill.







## DISPLAY WINDOWS

 **CALORIES:** Total calories burned or calories remaining left to burn during your workout.

 **TIME:** Set up your workout time and speed. Then start your work out.

 **DISTANCE:** Shown as kilometer. Indicates distance traveled or distance remaining during your workout.

 **SPEED:** Shown as KPH. Indicates how fast your walking or running surface is moving.

 **HEART RATE:** Shown as BPM (beats per minute). Used to monitor your heart rate (displayed when contact is made with both pulse grips).



## GETTING STARTED

- 1) Check to make sure no objects are placed on the belt that will hinder the movement of the treadmill.
- 2) Plug in the power cord and turn the treadmill ON. (The ON/OFF switch is next to the power cord.)
- 3) Stand on the side rails of the treadmill.
- 4) Attach the safety key clip to part of your clothing making sure that it is secure and will not become detached during operation.
- 5) Insert the safety key into the safety keyhole in the console.
- 6) You have two options to start your workout:

### A) QUICK START UP

Simply press the START key to begin working out.  
Time, distance, and calories will all count up from zero. OR...

### B) SELECT A WORKOUT OR TARGET

- 1) Select your PROGRAM with the +/- buttons and press ENTER when your desired PROGRAM is displayed.
- 2) Adjust the SETTING with the +/- buttons and press ENTER when your desired SETTING is displayed.
- 3) Press START to begin.



## WORKOUT PROFILES



P1) **MANUAL:** Adjust your speed manually during your workout.



P2) **DISTANCE:** Push yourself and go further during your workout with 13 distance workouts. Choose from L1: 1.6 km, L2: 3.2 km, L3: 5km, L4: 8 km, L5: 10km, L6: 12.8 km, L7: 15km, L8: 16 km, L9: 20km, L10: half marathon, L11: 24 km, L12: 32 km and L13: marathon goals. User sets starting speed levels.



P3) **TIME:** Set goals for Time. User could set up the speed and Incline to start.



P4) **CALORIES:** Set goals for burning calories. Calories burned are calculated using distance and speed.



**P5) FAT BURN:** A workout designed specifically to target fat. Promotes weight loss by increasing and decreasing the speed, while keeping you in your fat burning zone. Includes 10 levels.



Segment		Warm Up		1	2	3	4	5	6	7	8
Time		4:00 Mins		30 Sec	30 Sec	30 Sec	30 Sec	30 Sec	30 Sec	30 Sec	30 Sec
Level 1	Incline	0	0.5	1.5	1.5	1	0.5	0.5	0.5	1	1.5
	Speed(kph)	0.8	2.4	3.2	4	4.8	5.6	6.4	5.6	4.8	4
Level 2	Incline	0	0.5	1.5	1.5	1	0.5	1	0.5	1	1.5
	Speed(kph)	0.8	3	4	4.8	5.6	6.4	7.2	6.4	5.6	4.8
Level 3	Incline	0.5	1	2	2	1.5	1	1	1	1.5	2
	Speed(kph)	0.8	3.7	4.8	5.6	6.4	7.2	8	7.2	6.4	5.6
Level 4	Incline	0.5	1	2	2	1.5	1	1	1	1.5	2
	Speed(kph)	1.6	4.1	5.6	6.4	7.2	8	8.8	8	7.2	6.4
Level 5	Incline	1	1.5	2.5	2.5	2	1.5	1.5	1.5	2	2.5
	Speed(kph)	1.6	4.8	6.4	7.2	8	8.8	9.6	8.8	8	7.2
Level 6	Incline	1	1.5	2.5	2.5	2	1.5	1.5	1.5	2	2.5
	Speed(kph)	1.6	5.1	7.2	8	8.8	9.6	10.4	9.6	8.8	8
Level 7	Incline	1.5	2	3	3	2.5	2	2	2	2.5	3
	Speed(kph)	2.2	6.1	8	8.8	9.6	10.4	11.2	10.4	9.6	8.8
Level 8	Incline	1.5	2	3	3	2.5	2	2	2	2.5	3
	Speed(kph)	2.2	6.6	8.8	9.6	10.4	11.2	12	11.2	10.4	9.6
Level 9	Incline	2	2.5	3.5	3.5	3	2.5	2.5	2.5	3	3.5
	Speed(kph)	2.2	7.2	9.6	10.4	11.2	12	12.8	12	11.2	10.4
Level 10	Incline	2	2.5	3.5	3.5	3	2.5	2.5	2.5	3	3.5
	Speed(kph)	2.2	7.8	10.4	11.2	12	12.8	13.6	12.8	12	11.2



## **TO RESET THE CONSOLE**

Hold STOP key for 3 seconds.

## **FINISHING YOUR WORKOUT**

When your workout is complete, the unit will beep. Your workout information will stay displayed on the console for 30 seconds and then reset.

**Eng: Waste Disposal**

VISION Fitness / HORIZON Fitness / TEMPO Fitness / TREO Fitness products are recyclable.  
At the end of its useful life please dispose of this article correctly and safely (local refuse sites).

**Ger: Entsorgungshinweis**

Die Produkte VISION Fitness/HORIZON Fitness/TEMPO Fitness/TREO Fitness sind recycelbar.  
Führen Sie das Gerät am Ende der Nutzungsdauer einer sachgerechten Entsorgung zu (örtliche Sammelstelle).

**Dut: Verwijderingsaanwijzing**

VISION Fitness / HORIZON Fitness / TEMPO Fitness / TREO Fitness producten zijn recyclebaar. Breng het apparaat aan het einde van de gebruiksduur naar een in recycling gespecialiseerd bedrijf (plaatselijk verzamelpunt).

**Fre: Remarque relative à la gestion des déchets**

Les produits VISION Fitness / HORIZON Fitness / TEMPO Fitness / TREO Fitness sont recyclables. Lorsque cet appareil arrive en fin de vie, veuillez l'éliminer de manière correcte et en toute sécurité en le déposant dans une déchetterie communale.

**Ita: Indicazione sullo smaltimento**

I prodotti VISION Fitness / HORIZON Fitness / TEMPO Fitness / TREO Fitness sono riciclabili. Quando l'apparecchio non servirà più, portarlo in un apposito punto di raccolta della propria città (punti di raccolta comunali).

**Spe: Gestión de residuos**

Los productos de VISION Fitness / HORIZON Fitness / TEMPO Fitness / TREO Fitness son reciclables.  
Cuando se termine su vida útil, por favor deshágase de este artículo de forma correcta y segura en un punto limpio.

**Prb: Descarte**

Os produtos VISION Fitness / HORIZON Fitness / TEMPO Fitness / TREO Fitness são recicláveis.  
No final de sua vida útil, descarte este equipamento corretamente e com segurança (sites de locais de lixo).

**ChT: 廢棄物處理**

VISION Fitness / HORIZON Fitness / TEMPO Fitness / TREO Fitness 產品為可回收產品。  
產品的使用年限期滿後，請依照正確且安全的方式處理本廢棄商品 (當地的廢棄場)。

**ChS: 废弃物处理**

VISION Fitness / HORIZON Fitness / TEMPO Fitness / TREO Fitness 产品是可回收利用的。  
在其使用期结束后，请正确安全地 (在本地垃圾处理场) 处理本品。

